











**Step 5:** Adjust the angle by loosening the two adjustable handles on the side to allow the TV to tilt forward to 15 degrees or back to 5 degrees (Figure 6). Once the desired tilt angle is achieved, tighten the handle to secure the television in the new position. Take caution with wire clips to avoid damaging wires during angle adjustment.

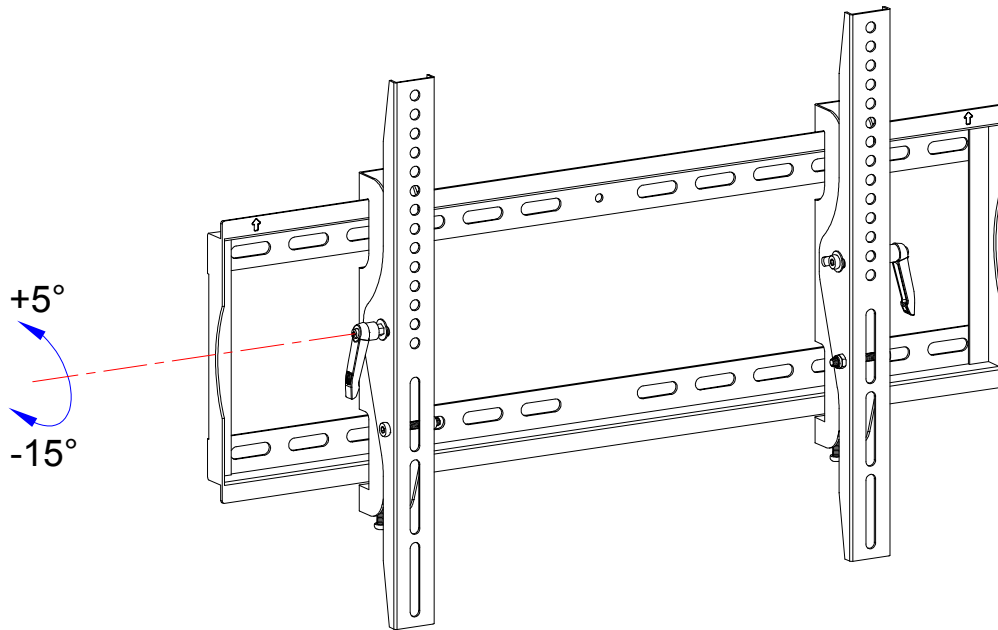
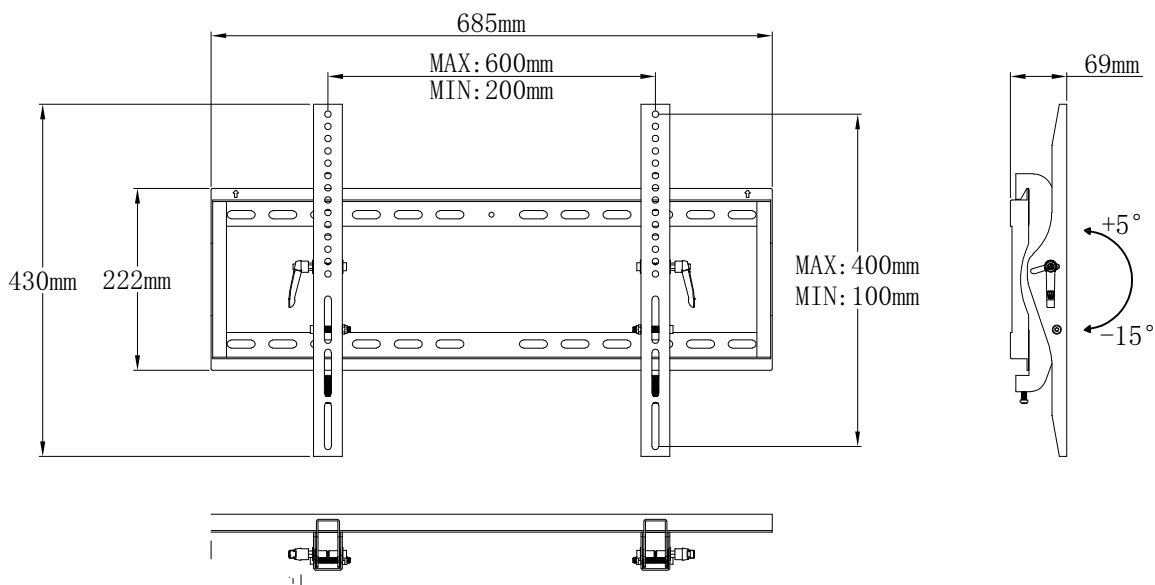

Figure 6

## Product dimensions:



**PAY EXTRA CARE AND ATTENTION WHEN YOU FASTEN TWO TV MOUNTS TO THE BACK PANEL OF TV IN STEP 3. MAKE SURE THE APPROPRIATE MOUNT HARDWARE IS BEING USED PROPERLY.**

1. Select correct Mounting Hardware according to the screw hole size of your TV, discard any remaining screws or spacers.
2. Carefully lay your TV on its face on a non-abrasive surface, making sure to lay padding underneath it so as not to damage the screen.
3. Place left TV mount and right mount in the appropriate position, making sure **CENTERED** on the back of the TV and **LEVEL** with on another.
4. This product only install on the perpendicular wall, not install on the ceiling.