

FULL-MOTION WALL MOUNT FOR LCD MONITORS AND DISPLAYS

INSTRUCTION MANUAL

SPECIFICATIONS

Display Size: up to 32"

Maximum Load: 25 kg (55 lbs)

Mounting Pattern: 75 mm x 75 mm, 100 mm x 100 mm, 200 mm x 100 mm, 200 mm x 200 mm

Tilt Range: +/- 13.8°

Pan/Swivel Range: up to 180°

Horizontal Rotation: 360°

Profile/Extension: 7.9 cm to 27.4 cm (3.1" to 10.8")

BOX CONTENTS

- | | |
|---|--|
| <input type="checkbox"/> Mount (x1) | <input type="checkbox"/> Instruction Manual (x1) |
| <input type="checkbox"/> Wall Plate (x1) | <input type="checkbox"/> Hardware Kit (x1) |
| <input type="checkbox"/> Adaptor Plate (x2) | |

WARNINGS

- 1 Read these instructions before you begin.** If you are unsure of any part of the process, contact a professional contractor or installer for assistance. Improper installation can result in injury or damage.
- 2 Do not use monitors or displays exceeding 25 kg (55 lbs) with this mount.** Using heavier displays may cause injury or damage.
- 3 The wall or mounting surface must be capable of supporting the combined weight of the mount and the display; if not, the structure must be reinforced.**
- 4 Safety gear and proper tools must be used.** Failure to do so can result in injury or damage.
- 5 Two people are recommended for installation.** Do not attempt to lift a heavy display without assistance.

WARNINGS (continued)

- 6 Follow all instructions and recommendations regarding adequate ventilation and suitable locations for mounting your display.** Consult the owner's manual for your particular display for more information.

TOOLS REQUIRED

- ☐ Phillips Head Screw Driver
- ☐ Electric or Portable Drill
- ☐ 3 mm (1/8") Drill Bit and Stud Finder for Drywall Installation
- ☐ 8 mm (5/16") Masonry Bit for Concrete Installation

HARDWARE KIT

(A) Drywall Screw (x3)

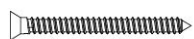

(B) Concrete Anchor (x3)



(C) M4 x 10 Screw (x4)



(D) Spring Washer (x4)



(E) M4 Nut (x4)



(F) M4 x 12 Screw (x4)



(G) M4 x 20 Screw (x4)



(H) M6 x 12 Screw (x4)



(I) M6 x 20 Screw (x4)



(J) Spacer (x4)



(K) S4 Allen Key (x1)



INSTALLATION

Part 1A – Mounting to the Wall (Drywall)

IMPORTANT! For safety reasons, this mount must be secured to a wood stud capable of supporting the combined weight of the mount and display. Do not mount to drywall alone.

Part 1A – Mounting to the Wall (Drywall) (continued)

- 1** Use a high quality stud finder to locate a stud where you wish to install your mount. Mark both edges of the stud to help identify the exact center.
- NOTE:** You must use the center of the stud to avoid cracking or splitting the wood during installation.
- 2** Place the wall plate against the wall and level it using the integrated bubble level.
- 3** Mark three locations for securing the mount to the wall (see Fig. 1) and set the wall plate aside.
- 4** Drill a 3 mm (1/8") pilot hole at each marked location.
- 5** Place the wall plate back against the wall and attach it using the drywall screws (A) provided (see Fig. 2). **Do not over-tighten these screws.** Ensure that the wall plate remains level after all screws are secured.

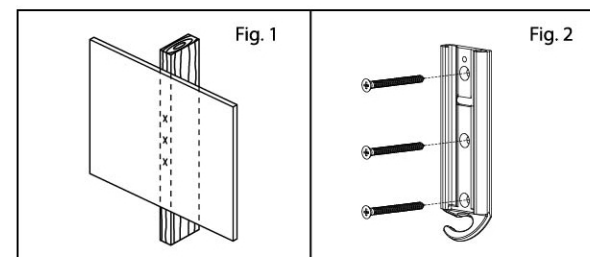

Part 1B – Mounting to the Wall (Concrete)

IMPORTANT! For safety reasons, the concrete wall must be capable of supporting the combined weight of the mount and the display. The manufacturer takes no responsibility for failure caused by walls of insufficient strength.

- 1** Place the wall plate against the wall in the desired location and level it using the integrated bubble level.
- 2** Mark three locations on the wall for securing the mount (see Fig. 3) and set the wall plate aside.

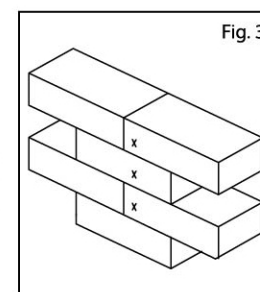

Part 1B – Mounting to the Wall (Concrete) (continued)

- 3 Drill an 8 mm (5/16") hole at each marked location. Remove any excess dust from the holes.

- 4 Insert a concrete anchor (B) into each hole so that it is flush with the concrete surface (see Fig. 4). A hammer can be used to lightly tap the anchors into place if necessary.

NOTE: If the concrete wall is covered by a layer of plaster or drywall, the concrete anchor must pass completely through the layer to rest flush with the concrete surface.

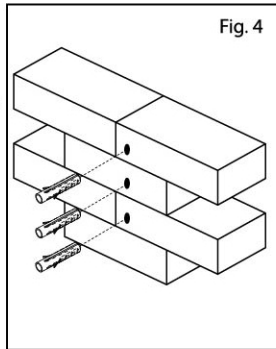

- 5 Place the wall plate back against the wall and attach it using the drywall screws (A) provided (see Fig. 2). **Do not over-tighten these screws.** Ensure that the wall plate remains level after all bolts are secured.

Part 2 – Attaching the Mount to the Display

IMPORTANT! Use extra care during this part of the installation. If possible, avoid placing your display facedown as it may damage the viewing surface.

NOTE: This mount comes with a selection of different screw diameters and lengths to accommodate a wide variety of display models. Not all of the hardware in the kit will be used. If you cannot find the appropriate screw size in the kit provided, consult the manufacturer of your display for more information.

- 1 Examine the mounting holes on the back of your display:

- A If the mounting holes are spaced 75 mm x 75 mm or 100 mm x 100 mm apart, skip this section and proceed with Step 2.

- B If the mounting holes are spaced 100 mm x 200 mm or 200 mm x 200 mm apart, you will need to use the adaptor plates included with your mount. Attach these to the mount according to the illustration (see Fig. 5). Use the M4 x 10 screws (C), spring washers (D), and M4 nuts (E) from the hardware kit.

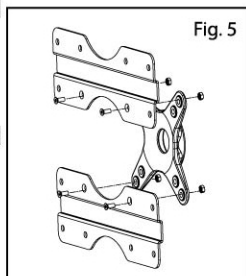

Part 2 – Attaching the Mount to the Display(continued)

- 2 Determine the correct length of screw to use by examining the back of your display:

- A If the back of your display is flat and the mounting holes are flush with the surface, you will use the shorter screws (F or H) from the hardware kit.

- B If the back of your display is curved, has a protrusion, or if the mounting holes are recessed, you will need to use the longer screws (G or I) and the spacers (J).

- 3 Determine the correct diameter of screw to use by carefully trying one of each size (M4 and M6) from the hardware kit.

Do not force any of the screws – if you feel resistance stop immediately and try a smaller diameter screw.

- 4 Attach the mount arms to the back of your display using the screws identified in Steps 2 and 3. If you are using the longer screws on a display with a curved or recessed back, you may also need to use the spacers (J). **Only use a spacer if necessary.**

NOTE: If the holes of the mount do not line up with the holes on your display, check to make sure that your display is VESA compatible. This mount can only be used with displays that are VESA 75, VESA 100, VESA 100 x 200, or VESA 200 compatible. Consult the manufacturer of your display for more information.

Part 3 – Final Assembly

- 1 To complete the installation, carefully slide the mount with your display attached into the wall plate (see Fig. 6). **Do not release the display until the mount is securely placed in the wall plate.** If you need to remove the mount from the wall, carefully slide the mount upwards and out of the wall plate.

- 2 Tighten the set screw located on the upper front portion of the wall plate using the S4 Allen key (K) from the hardware kit (see Fig. 7). Remember to remove the set screw before attempting to remove the mount from the wall plate.

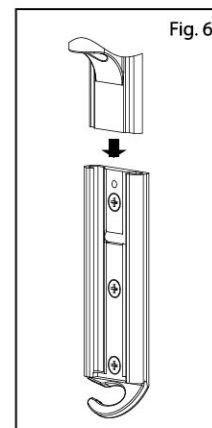

Part 3 – Final Assembly (continued)

IMPORTANT! The set screw should be used at all times to prevent the mount from being accidentally lifted from the wall plate.

- 3 Cables can be routed through the hook located at the bottom of the wall plate to keep them organized and out of the way.

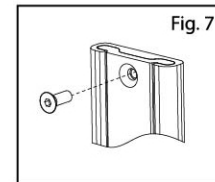

OPERATION AND ADJUSTMENT

- 1 To adjust the tilt angle or rotate your screen, firmly grasp the sides of your display and carefully move it into position. If you find the mount is too difficult to move or is too loose to hold your mount in position, adjust the three screws located directly behind the head of the mount using the S4 Allen key (K) from the hardware kit (see Fig. 8). Adjust all three screws evenly.
- 2 Swivel adjustments can be made simply by moving your display to the desired position. If any of the swivel joints are too tight or too loose, they can be adjusted using the S4 Allen key (K) from the hardware kit (see Fig. 9).
- 3 Periodically clean your mount with a dry cloth. Inspect all screws and hardware at regular intervals to ensure that no connections have become loose over time. Re-tighten as needed.

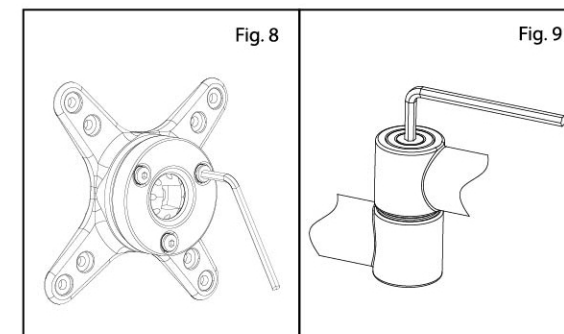

EAM32

Metra Electronics Corp. · 460 Walker Street · Holly Hill, FL 32117-2653
Help: (866) 839-9187 · www.etherealhometheater.com